

# EXECUTIVE MEETING CENTER

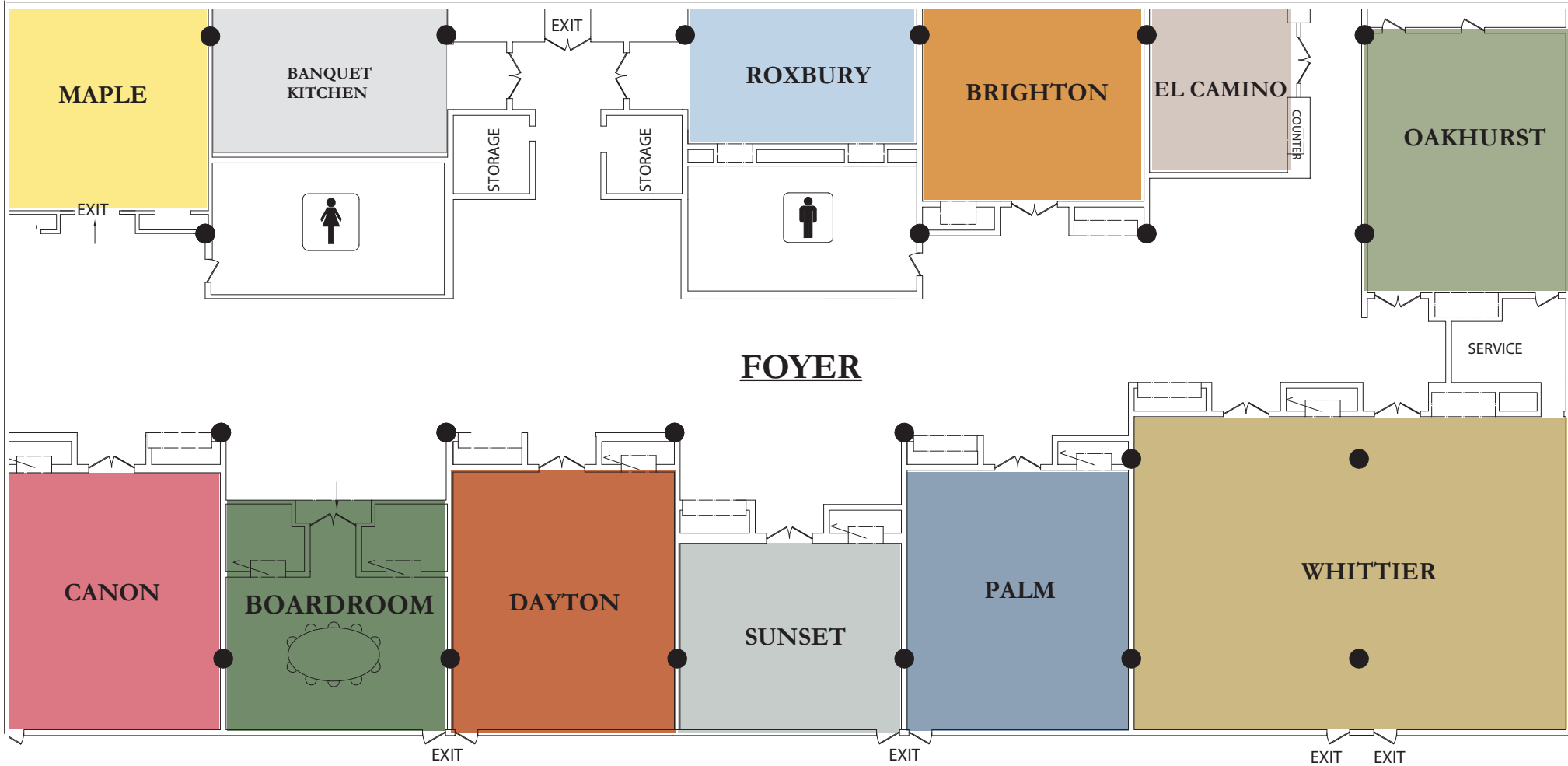

<b>EXECUTIVE MEETING CENTER</b>	<b>Sq. Feet</b>	<b>Theater</b>	<b>Classroom</b>	<b>Conference</b>	<b>U-Shape</b>	<b>Hollow Square</b>	<b>Banquet</b>	
12. Whitter	2,398	160	110	36	36	40	160	
13. Palm	1,000	70	60	26	26	28	80	
14. Sunset	726	60	35	20	22	28	60	
15. Dayton	1,000	70	60	26	26	28	80	
16. Board Room	717		Permanent Boardroom Seating for 18					
17. Canon	1,000	70	60	20	22	28	80	
18. Oakhurst	1,000	72	35	26	26	28	60	
19. El Camino	490	32	20	16	16	20	40	
20. Brighton	1,000	70	60	26	26	28	80	
21. Roxbury	696	40	35	20	22	28	60	
22. Maple	1,000	70	60	26	26	28	80	